

Parameters

Electrical Parameters (from HDL-MPLPI.48-A):

Power Supply	DC12-30V
Power consumption	20mA/DC24V

Environmental Conditions:

Working Temperature	-5°C~45°C
Working relative Humidity	Up to 90%
Storage Temperature	-20°C~+60°C
Storage relative Humidity	Up to 93%

Approved

CE

RoHS

Product Information:

Dimensions	86×86×10.5 (mm)
Net weight	105g
Housing material	Glass, ABS,PC, Aluminum
Installation	EU wall box
Protection rating	IP20

Important Notes

- It must work in conjunction with HDL-MPLPI.48-A
- **Real product may be different from pictures in the right**
- Touch performance – touch panel sensitivity need to be readjusted after installation
- Buspro cable — HDL Bus/KNX cable, 0.8mm single core copper cable.
- Buspro Connection — Series connection (hand-in-hand).
- Installation — EU wall box.

Installation Steps

- Connect bus cables. Make sure the color of wire complies with the definition
- Make sure the Bus cable type is correct and has no short circuit
- Mount the HDL-MPLPI.48-A in the wall-box
- Put this device into HDL-MPLPI.48-A

HDL Buspro Cable Guide

CAT5/CAT5E	HDL Buspro	HDLBuspro/KNX
Brown/ Orange	DC24V	Red
Brown white/ Orange white	COM	Black
Blue white/Green white	DATA-	White
Blue/ Green	DATA+	Yellow

Overview



HDL-MPT2.48-A



HDL-MPT4.48-A

Multi-function touch control panel, embedded with RGB LED backlight for each touch button, any color is available for the button via setting in HDL Buspro configuration tools software.

Functions

- Key Mode: Single on/off, Single on, Single off, Combination on, Combination off, Combination on/off, Momentary, Short/long press, Short press/long press.
- Key Control Type: Scene, Sequence, Timer, Universal Switch, Single Channel Control, Broadcast Scene, Broadcast Channel, Curtain Control, GPRS Control, Panel Control, Security Module, Music Play, Universal Control, etc.
- Test bus voltage function
- Adjustable backlight color and intensity.
- Supports HDL Buspro online upgrading.
- Customized image for touch panel.

Safety Precautions



- The screw down torque should not exceed 0.1Nm
- Mounting position: indoor
- Do not make wrong connection on Buspro interface, it will damage the Buspro interface of this module
- Never let liquids get into module, it will damage this device
- Do not get AC power into Bus wire, it will damage all devices in the system



Dimensions and Wiring

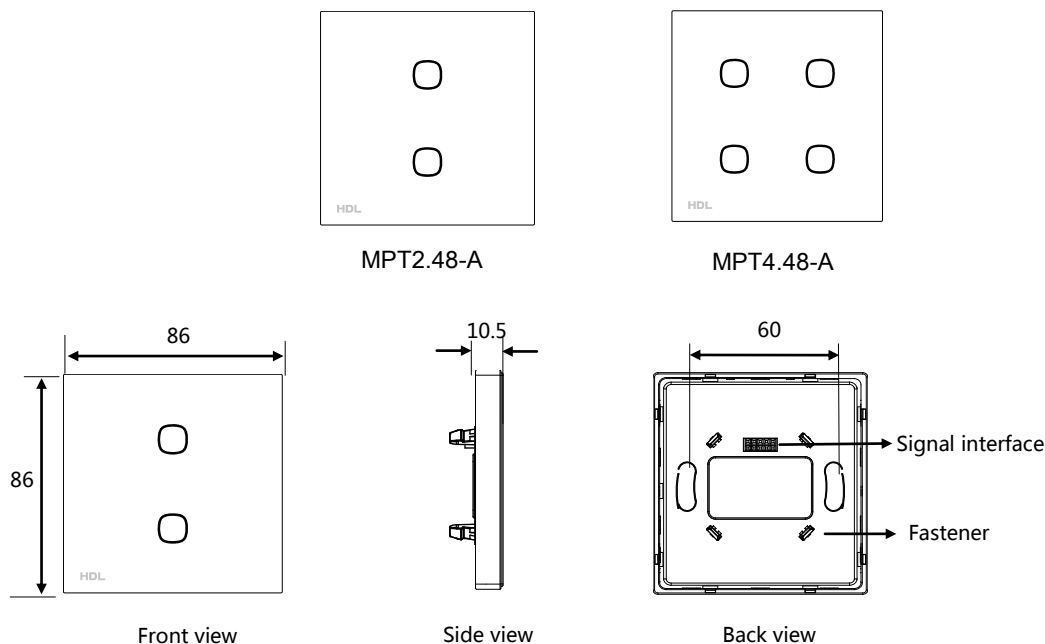

Touch button function: On/off, dimming

Address modification: keep pressing any of button for 15s, all the backlights will flash, the address of this device can be changed on HDL Buspro software: Submenu "address management→address modify"

Signal interface and fastener: Connect to panel power interface (MPLPI.48-A).

Installation

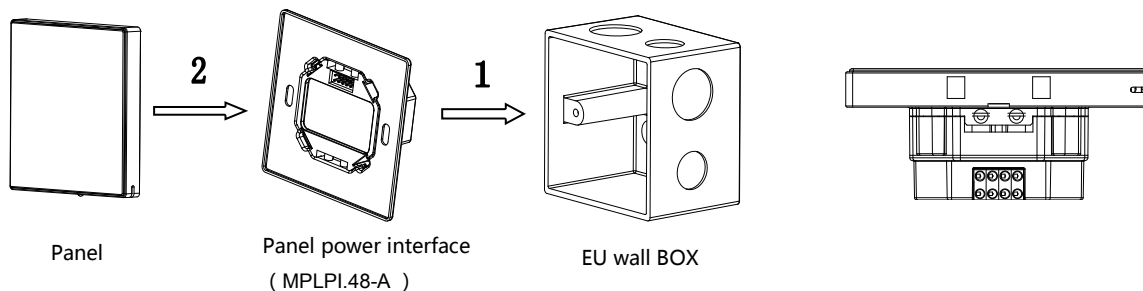

Installation: Hold the edge of panel, insert the power interface module vertically. Do not push the panel too hard.

Split: Panel and panel power interface by magnetic suction, you can split them apart directly.

Package Contents

- Datasheet*1 / Panel *1